

Large Headless Screw™

Surgical Technique | *TriMed Cannulated Screw System™*

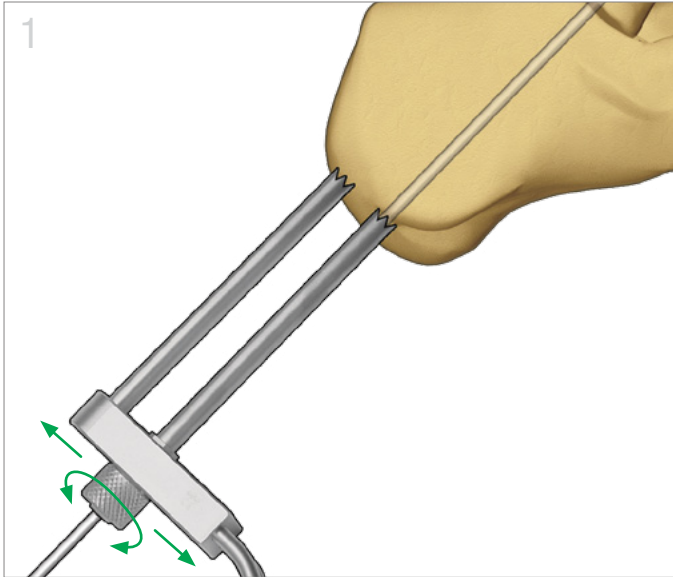

Insert Guide Wire

- Select desired distance on Parallel K-wire Sleeve and adjust the movable sleeve to the desired position.
- Tighten the lock nut on the adjustable sleeve to secure its location.
- Insert appropriately sized K-wire(s) to desired depth.

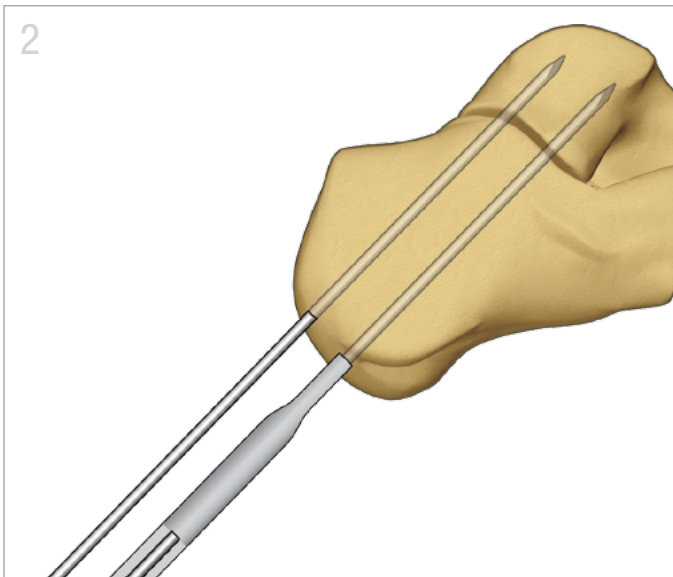

Measure Depth

- Measure K-wire depth with Wire Gauge.
- When possible, advance K-wire beyond intended screw length to prevent K-wire from being extracted with drill.

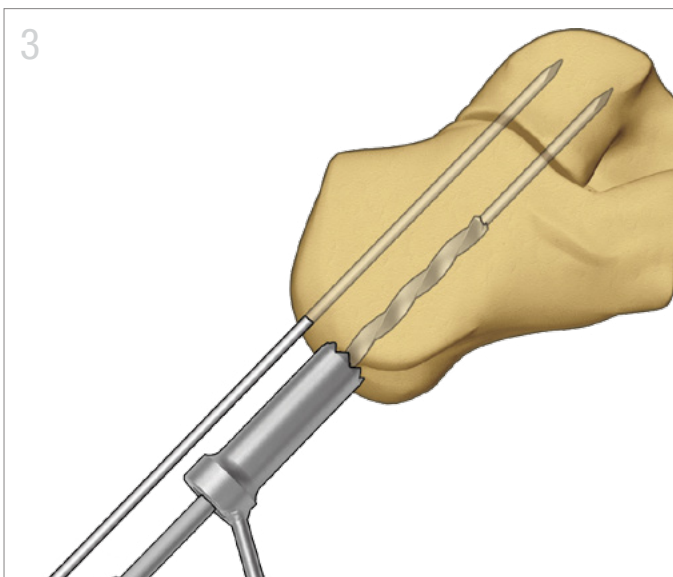

Drill Hole

- Place Tissue Protector.
- Drill to desired depth. Confirm with C-arm.
- Use corresponding sized Countersink.

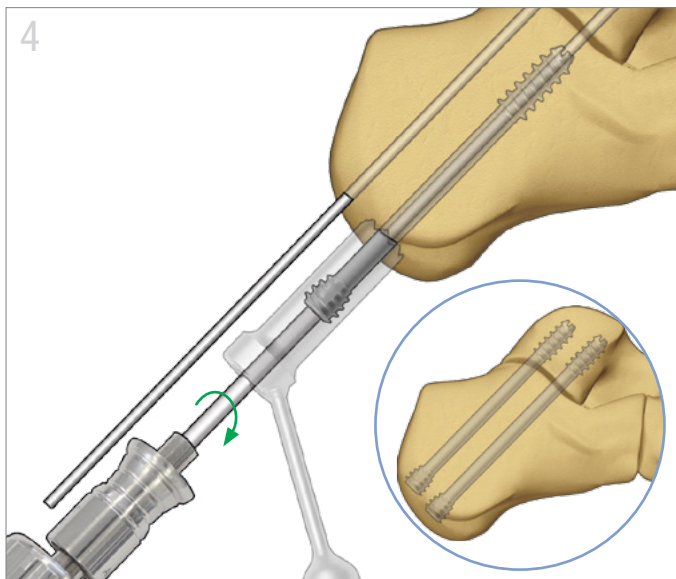

Insert Screw

- Select appropriate screw length and drive screw until flush with bone.
- Remove K-wire.
- Repeat the previous steps for additional screw placement.

TIPS

- Inserting screws by hand is recommended as power driven screws can lead to increased heat generation.
- Avoid applying too much torque, which can damage the screw head and/or driver.

Large Headless Screw

All implants made from surgical grade stainless steel

Screws shown at actual size:

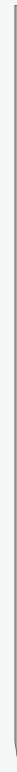

Screw	Length*	Thread	Head	Parallel K-wire Guide	K-wire	Drill	Countersink
4.5 S45xx ■	26-44mm* 44-64mm**	4.5mm	5.5mm	GUIDEP-2.5/2.5	WIRE-1.6/230	DRILL-3.2/220C	HSINK-4.5
5.5 S55xx L55xx ■	26-44mm* 44-64mm**	5.5mm	6.7mm	GUIDEP-2.5/2.5	WIRE-2.0/230	DRILL-4.0/220C	HSINK-5.5
7.3 S73xx L73xx ■	44-112mm**	7.3mm	8.5mm	GUIDEP-2.5/2.5	WIRE-2.5/230	DRILL-5.1/220C	HSINK-7.3

*2mm Increments available

**4mm Increments available
Long threads available in select lengths



TriMed, Inc. / 27533 Avenue Hopkins / Valencia, CA 91355 USA / 800-633-7221 / www.trimedortho.com

Patent Coverage: TriMed, Inc. products are covered by patents issued in the U.S. and in foreign jurisdictions. The presently issued U.S. patents are: 5,709,682; 5,931,839; 5,941,878; 6,077,266; 6,113,603; 7,037,308; 7,195,633; 7,540,874; 8,177,822; 8,821,508; 8,906,070; 9,089,376; 9,283,010; 9,220,546. The TriMed Large Headless Screw has U.S. and international patents pending. TriMed Large Headless Screw is a trademark of TriMed, Inc.

The technique presented is one suggested surgical technique. The decision to use a specific implant and the surgical technique must be based on sound medical judgment by the surgeon that takes into consideration factors such as the circumstances and configuration of the injury.

